

LAND & HOUSE OF GITA DAS & OTHERS (VACANT LAND)

2 STORED BUILDING

PLACED IN THE BUILDING COMMITTEE MEETING HELD ON 20.12.2020 & RECOMMENDED

COMPONENTIALLY APPROVED THE PLAN AND NOTICE REGARDING INSPECTION BEFORE LAY OUT PLAN & CASTING OF FOUNDATION & ROOF CASTING OF BUILDING IS ATTACHED

THIS PLAN IS CONDITIONALLY SANCTIONED THAT NO OBJECTION CERTIFICATE FROM FIRE SERVICE IS REQUIRED BEFORE OCCUPANCY CERTIFICATE



Passed in the meeting of Board of Administrators Held on 05.01.2021

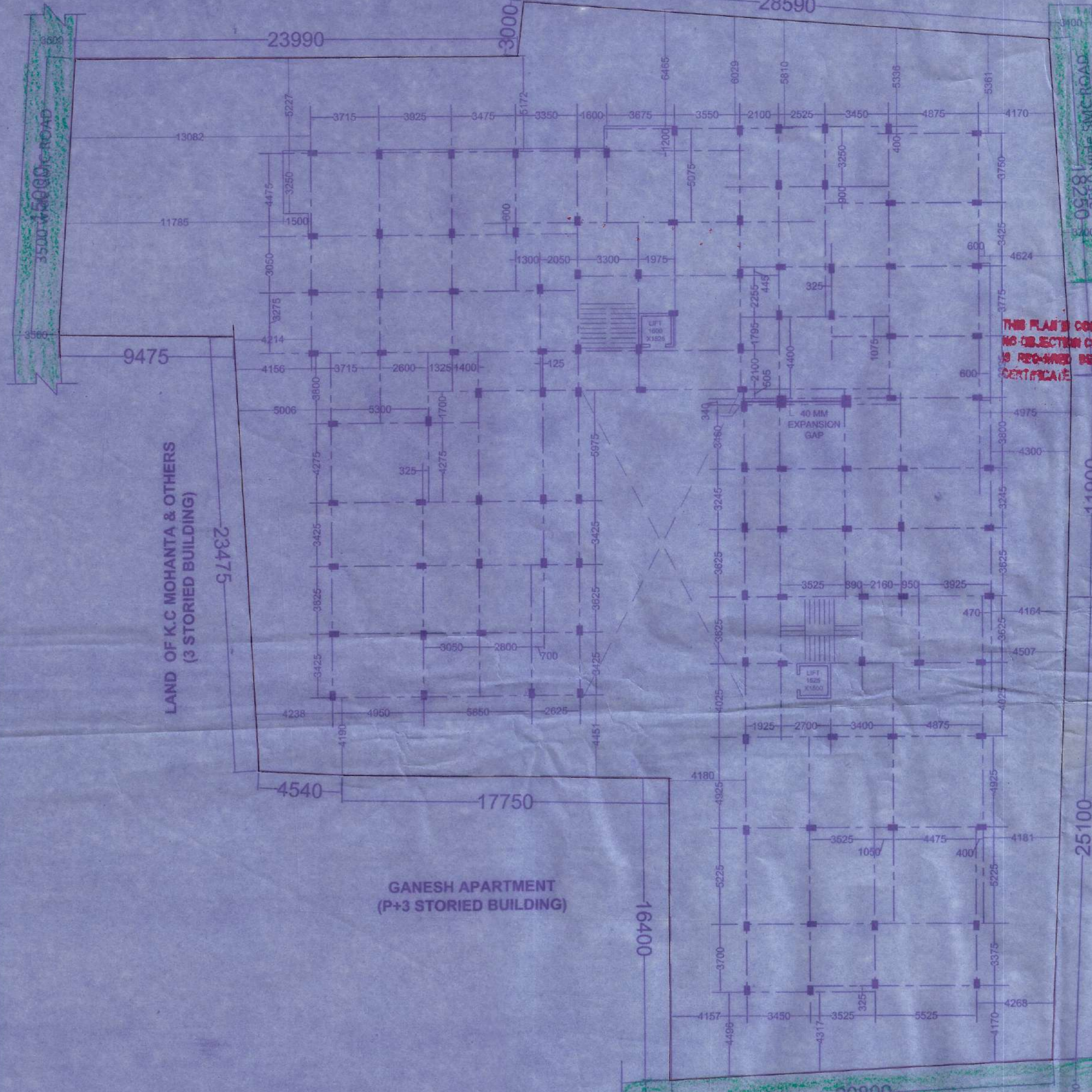

COLUMN LAYOUT PLAN SCALE: 1:200

LAND & HOUSE OF GITA DAS & OTHERS (VACANT LAND)

2 STORED BUILDING

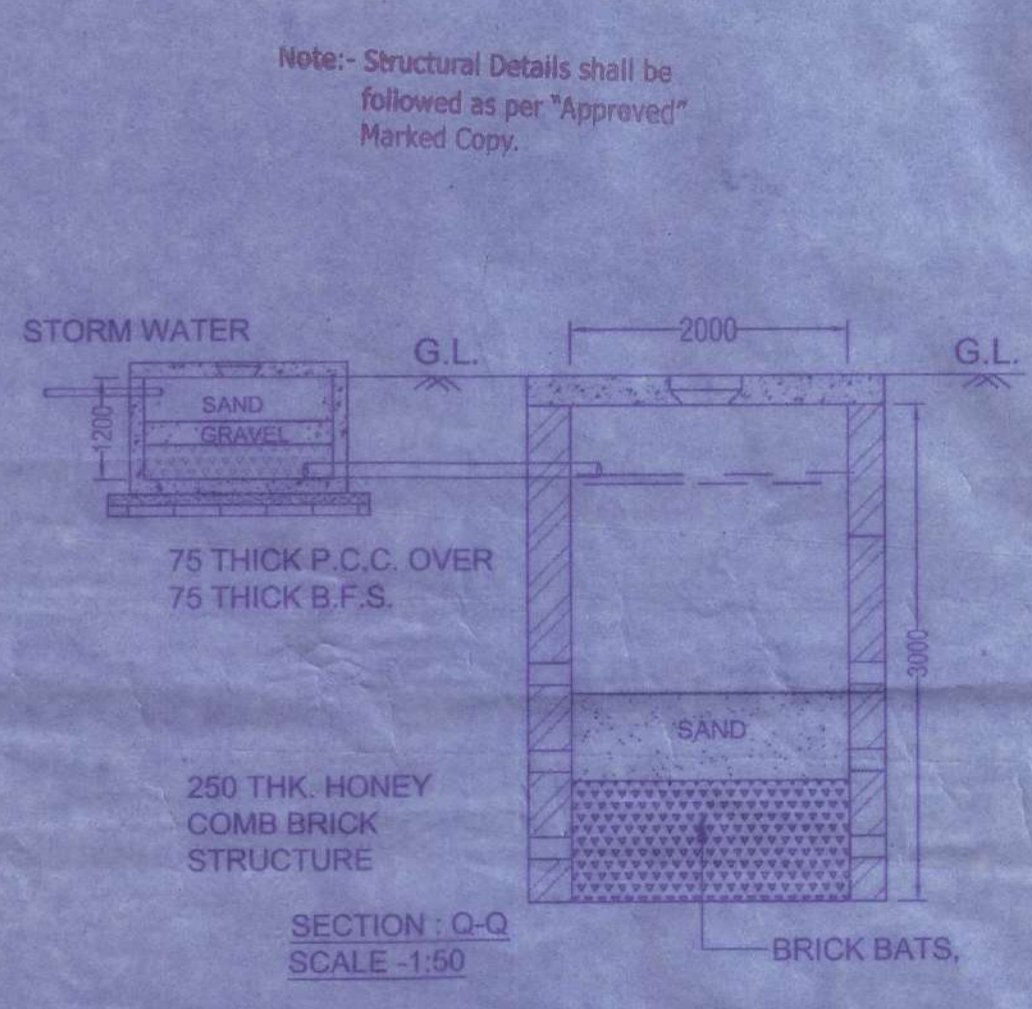

SECTION: Q-Q SCALE: 1:50

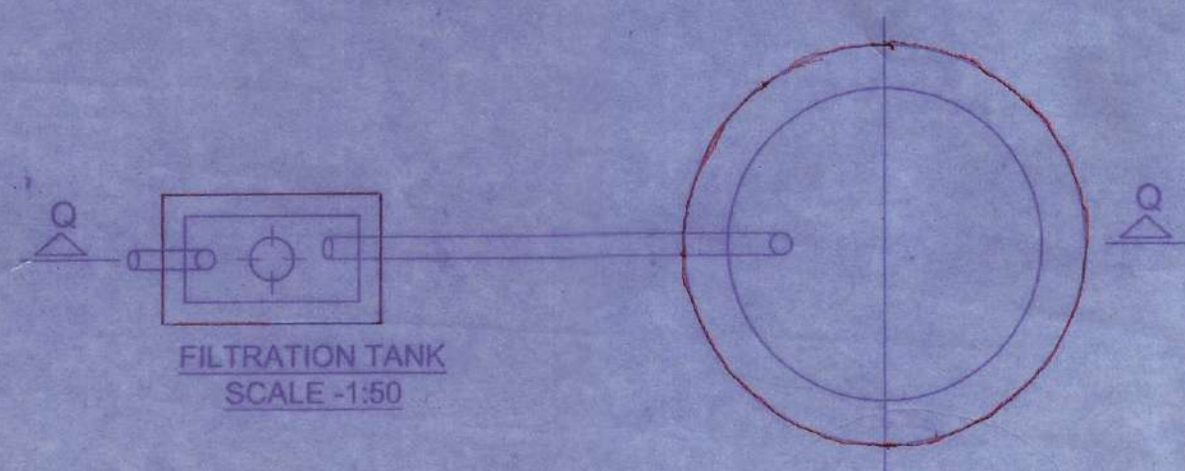

DETAIL OF RAIN WATER HARVESTING SCALE: 1:50

May be Sanctioned
How to sanction
Signature
Date

ASST. ENGINEER
SILIGURI MUNICIPAL CORPORATION
Excutive Engineer
Siliguri Municipal Corporation
Siliguri

SANCTIONED
Commissioner
Siliguri Municipal Corporation

LAND OF K.C. MOHANTA & OTHERS (3 STORED BUILDING)

LAND OF GAUTAM KAR & OTHERS (TIN SHED SIP STRUCTURE)

PROP. GROUND (PARKING) + 4 STD. RESIDENTIAL BUILDING

Valid for Three Years From the Date of Sanctioned 05.08.2021
GANESH APARTMENT (P+3 STORED BUILDING)

SITE PLAN SCALE: 1:200

SPECIFICATIONS

- SOLING 75 THICK WITH FIRST CLASS BRICK.
- R.C.C. 1:1.5:3 CEMENT CONCRETE.
- P.C.C. 1:3:6 CEMENT CONCRETE.
- D.P.C. 1:2:4 CEMENT CONCRETE.
- STEEL Fe - 500 GRADE.
- MARBLE FLOORING IN ALL ROOMS.
- MARBLE IN TOILET AND KITCHEN.
- BRICK WALL 125 THICK AND 250 THICK WITH 1:4 MORTAR.
- FRAME SIZE FOR DOORS/WINDOWS 100 X 75 mm.
- PLASTIC PAINTS IN INTERIORS.
- CEMENT PAINTS IN EXTERIORS.
- SYNTHETIC ENAMEL IN DOOR/WINDOWS.
- DIMENSIONS ARE IN MM.
- APPROVED L.U.C. NO. DATE: -
- APPROVED SITE PLAN NO. -
- GRADE OF CONCRETE - M20

SCHEDULE OF OPENINGS

D	1050 X 2100
D 1	900 X 2100
D 2	750 X 2100
W	1800 X 1350
W 1	1500 X 1350
W 2	1200 X 1350
Y	600 X 750
C.G	1200 X 2100



CERTIFICATE OF STRUCTURAL STABILITY

I / do hereby certify that the foundation and superstructure of the building proposed for construction on plot R.S.533, L.R. 83 Street I.T.I. ROAD Ward No. 41 under the jurisdiction of SILIGURI Municipality / Notified Area Authority / Industrial Township Authority have been personally inspected and so designed by me/ Us will make such foundation and super structure safe in all respect including the consideration of bearing capacity and settlement of soil and other conditions, if any, conforming to all stipulations of all relevant IS Code of practice and National Building code.

Signature of Structural Engineer
(Name, Address and empanment No.)

Signature of Geo-technical Engineer
(Name, Address and Empanment No.)

PROJECT TITLE

PROPOSED GROUND(PARKING) + FIVE STD. RESIDENTIAL BUILDING OF (1) SRI. AMAN AGARWAL, PARTNER OF N.B. DEVELOPERS, (2) SRI. MAHESH KR. AGARWAL, (3) SMT. BADAMI DEVI AGARWAL AND (4) RAHUL AGARWAL, AT I.T.I. ROAD, JOYTINAGAR, SILIGURI, P.S. BHAKTINAGAR, DIST. JALPAIGURI, WARD NO. 41. (S.M.C.)

CERTIFICATE OF BUILDING PLAN

I do hereby declare that the building proposed for construction shall be supervised by the L.B.A. / L.B.S. signing the Building Plan Application or in his/her absence by any other L.B.A. / L.B.S. of the appropriate category and as approved by the authority.

I / We do hereby certify that plans, elevations and sections and other structural details of the proposed building on Plot No. R.S.533, L.R. 83 Ward No. 41, under the jurisdiction of S.M.C. Municipality / Notified Area Authority / Industrial Township Authority have been prepared in conformity with all relevant provisions under the West Bengal Municipal (Building) Rules, 2007. This also to certify that all relevant 'No objection' Certificates form the respective Authorities such as, Fire and Emergency Services Department, Airport Authority, Pollution Control Board, Telecommunication Department etc. as applicable in this regard, are also enclosed with the application for seeking approval of the plan to construct/ reconstruct/ addition to / alteration of the building on the said plot.

Signature
Date

N B DEVELOPERS
Partner

SIGNATURE OF OWNER

Signature of Licenced Building Surveyor/Architect (Name, Address and Empanment No. / Registration No.)

CONSULTANT: BHADRA ARCHITECTS & ENGINEERS
457 BIDHAN ROAD, SILIGURI